



# WL38G

LINEAR GRAZER MEDIA LUMINAIRE



Profile Type	38mm width 6063 aluminium linear profile
Profile Finishing	Powder coating
Cover	Clear
Light Uniformity	Dot Visible
Mounting	Adjustable mounting bracket
Compatible LED Module	- (non modular)
CRI	High Efficiency (CRI~80)
SDCM	3 step MacAdam ellipse binning
Lifetime	Up to 50,000 hours L80 lamp life at Ta = 25°C
Voltage	24V DC, 48V DC, 220-240V AC
Maximum Power	48W/m
Length Options	300mm, 500mm, 1000mm
Operating Temperature	Ta (min) = -35°C, Ta (max) = +60°C
Wire Connection	Supplied with insulated IP66 wires and connector at 200mm length
IP Rating	IP66
IK Rating	IK06
Profile LOR	-
<b>Media Specifications</b>	
Pixel Density	8 Pixel per meter
Control Method	DMX 512 - Pixel by Pixel
Cut per Stretch	300mm (4 pixel), 500mm (6 pixels), 1000mm (8 pixels)

### AVAILABLE OPTIONS

#### CCT OPTIONS

##### SINGLE CCT

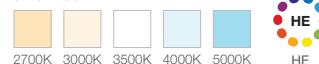

##### RGBW

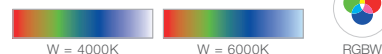

#### BEAM ANGLES

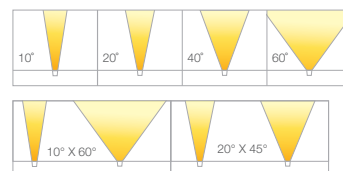

### DIMENSIONS (MM)

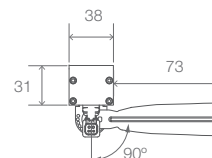
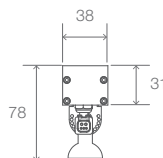
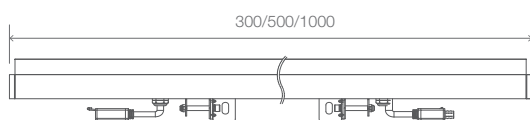

(Optional)



## FACADE LIGHTING

### PRODUCT SPECIFICATIONS

Model	WL38G LINEAR GRAZER MEDIA LUMINAIRE		
Cut Length	300mm	500mm	1000mm
Light Source	White LED, RGBW		
Colour Temperatures	White 2700K, 3000K, 3500K, 4000K, 5000K, RGBW(4000K), RGBW(6000K)		
LED Quantity	6pcs	12pcs	24pcs
Luminous Flux	White 3000K: 1080 lm (60°)	White 3000K: 1800 lm (60°)	White 3000K: 3600 lm (60°)
Pixel Options	1 pixels	1, 4 pixels	1, 4, 6, 8 pixels
Efficacy	White 3000K: 75 lm/W (full on 60°)		
Beam Angles	10° / 20° / 40° / 60° / 10° x 60° / 20° x 45°		
Lens	Glass		
Housing	Aluminium		
Housing Finish Options	Matt Grey (RAL7001), Matt Black (RAL9011)		
Adjustment Options	0 to +90°		
Mounting	Adjustable Mounting Bracket		
Dimensions (L x W x H, Mounting Bracket included)	300mm x 38mm x 78mm	500mm x 38mm x 78mm	1000mm x 38mm x 78mm
Weight	0.6kg	0.9kg	1.60kg
Regulatory Listing & Safety Approval	CE		
Operating Temperature	-30°C to +50°C		
Minimum Starting Temperature	-20°C		
Environment	Outdoor, IP66, IK06, Coastal Environment (ASTM B117-16)		
Humidity	85%, non-condensing		

### ELECTRICAL SPECIFICATIONS

Input Voltage	24V DC, 48V DC, 220-240V AC		
	48W per meter		
System Power	16W	24W	48W
LED Power	12.8W	19.2W	38.4W
Lumen Maintenance	L80 50000hrs @ 25°C		

### SYSTEM SPECIFICATIONS

Power Supply	CE market: LED Engine 24V
	ETL market: LED Engine 24V (Class 2)
Control	On / Off, DMX512



## FACADE LIGHTING

### PHOTOMETRICS

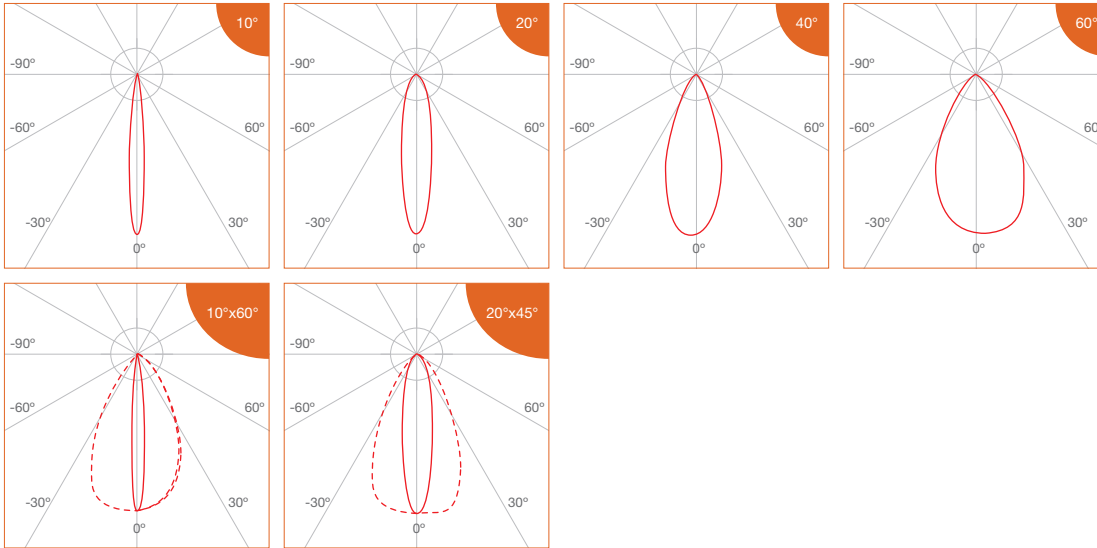

### SPECIFICATIONS

#### • Single CCT

CCT	Efficacy (lm/W)	Luminous Flux per meter (lm/m)
		48W/m
2700K	75.0	3600
3000K		
3500K		
4000K	78.8	3780
5000K		

#### • RGBW

CCT	Efficacy (lm/W)	Luminous Flux per meter (lm/m)	RGB Wavelength (nm) / White CCT
		48W/m	
Red	203.9	412 (@4.03W)	620 - 630
Green	310.0	887 (@5.71W)	515 - 525
Blue	82.8	237 (@5.71W)	460 - 470
White	483.5	2065 (@8.54W)	4000K 6000K



## FACADE LIGHTING

### ORDERING MATRIX

Profile	Input Voltage		Finishing		Cover		Beam Angle		Length		Pixel Options		Accessories	
WL38G-PIX	24	24V DC	GR	Matt Grey	C	Clear	10	10°	300	300mm	1P	1 Pixel	N	None
	48	48V DC	MB	Matt Black			20	20°	500	500mm	1P	1 Pixel	AGB	Anti-glare Baffle
	AC	220-240V AC					40	40°			4P	4 Pixels		
			60	60°	1000	1000mm	1P	1 Pixel						
			10X60	10° x 60°			4P	4 Pixels						
			20X45	20° x 45°	6P	6 Pixels	AGM	Micro Louvre						
					8P	8 Pixels								

LED Module Power & CCT				Ingress Protection		Control		
Single CCT	48	48W/m	27	2700K	IP66	IP66	ND	On/Off
			30	3000K			DMX	DMX512
			35	3500K				
			40	4000K				
			50	5000K				
RGBW			RGBW40	RGBW (4000K)				
			RGBW60	RGBW (6000K)				

Example: WL38G-PIX-24-GR-C-20-1000-8P-AGB-48-30-IP66-DMX  
 WL38 Grazer Profile, Pixel Control, 24V DC, Matt Grey, Clear cover, 20°, 1000mm, 8 Pixels, Anti-glare Baffle, 48W/m, 3000K, IP66, DMX512



# LINEAR PROFILE AND ACCESSORIES

(Ordering Matrix for Separate Orders)

## • Terminal Cable

Power supply or signal for male/female terminal of lighting fixture with controller

Type	Number of Cores		Length	
WL-C	2P	2 poles (On/Off)	220	220mm
	5P	5 poles (TW/RGBW/DMX)	1000	1000mm

example: WL-C.5P.1000

## • Inter-connector Cable

Used in power supply or signal jumper connection for lighting fixture

Type	Number of Cores		Length	
WL-IC	2P	2 poles (On/Off)	1000	1000mm
	5P	5 poles (TW/RGBW/DMX)		

example: WL-IC.5P.1000

## • T-connection Cable

Cable used in intermediate power supply for lighting fixture with controller

Type	Number of Cores		Length	
WL-TC	2P	2 poles (On/Off)	300	300mm
	5P	5 poles (TW/RGBW/DMX)	600	600mm

example: WL-TC.5P.600

## • Termination End Cap

Cable used in intermediate power supply for lighting fixture with controller

Type	Number of Cores	
WL-EC	2P	2 poles (On/Off)
	5P	5 poles (TW/RGBW/DMX)

example: WL-EC.5P